



MetaFi enables real-time management of field-based inventory, assets, and employees allowing manufacturers and service providers to increase revenue, productivity and compliance. MetaFi leverages RFID and wireless technologies to provide the means to automatically collect, analyze, and act on real-time data from mobile field representatives and remotely located smart-containers including cabinets, totes, and shelves.

FEATURES:

- >> Turn-Key, Web-Based Application
- >> Rich Browser-based GUI
- >> Real-time Visibility / Analysis
- >> Central Data Management
- >> Role-based User Access
- >> Central Policy Management
- >> Edge Policy Enforcement
- >> Support for 3rd party Mobile Phone and RFID Readers
- >> Web Services Interface to 3rd-party Applications

TARGET INDUSTRIES:

- >> Consumer Goods
- >> Energy Utilities
- >> Hospitality Services
- >> Industrial Goods
- >> IT Services
- >> Medical Devices
- >> Oil & Gas
- >> Transportation Services



MetaFi Application Service

### Solution Overview

MetaFi is a turn-key hosted application that enables real-time management of mobile inventory, assets, and employees allowing manufacturers and service providers to increase revenue, efficiencies, and compliance. While much of the attention in the RFID market has focused on middleware used to reduce supply chain costs – MetaFi is a purpose-built RFID application used to increase sales chain revenue and efficiencies. Designed for setup and use by line of business users, MetaFi facilitates rapid deployment, typically in days or weeks, and creates value for various functional groups due to its web-based, business-oriented dashboards and analytics.

MetaFi is based on a mobile web services architecture and leverages RFID and wireless technologies that provide the means to automatically collect, analyze, and act on real-time data from mobile field representatives and remotely located smart-containers including cabinets, totes, and shelves. MetaFi also provides the same benefits to on-premises applications by leveraging WiFi or Ethernet connectivity to provide real-time data collection.

### Solution Benefits

Manufacturers and service providers currently struggle to gather accurate and timely data on field inventory and asset levels due to manual tracking methods inconsistently employed by time-constrained field representatives. MetaFi enables automated real-time inventory and asset visibility resulting in the following benefits across the organization:

- **Increased sales productivity / revenue**
  - o More stock-ins
  - o Increase in effective sales coverage / capacity
- **Increased operational efficiency**
  - o Decreased out-of-stocks / shrinkage
  - o Better forecasting accuracy
  - o Higher inventory turns
  - o Higher SLA attainment
- **Increased financial performance**
  - o Less working capital
  - o Faster invoice-to-cash collection
  - o Fewer write-downs

**About SkyeTek:**

SkyeTek delivers a turn-key hosted solution that enables real-time management of inventory and resources from the distribution center to customer sites allowing manufacturers and service providers to increase revenue, productivity, and compliance. SkyeTek leverages an ecosystem of resellers, systems integrators, and reader / printer / tag manufacturers to deliver optimal value to its customers.

**For more information:**

11030 Circle Point Road, Ste 300  
Westminster, Colorado 80020 USA  
ph: 720.565.0441  
[www.skyetek.com](http://www.skyetek.com)



Copyright © 2005-2008 SkyeTek, Inc.

SkyeTek®, Tagnostic®, SkyeWare™, Physical made Digital™, TagIQ™, ReaderDNA™, SkyeModule™ and AURA™ are trademarks or registered trademarks of SkyeTek, Inc. All other trademarks or brand names are the properties of their respective holders. Features and specifications are subject to change without notice. ver. 080723

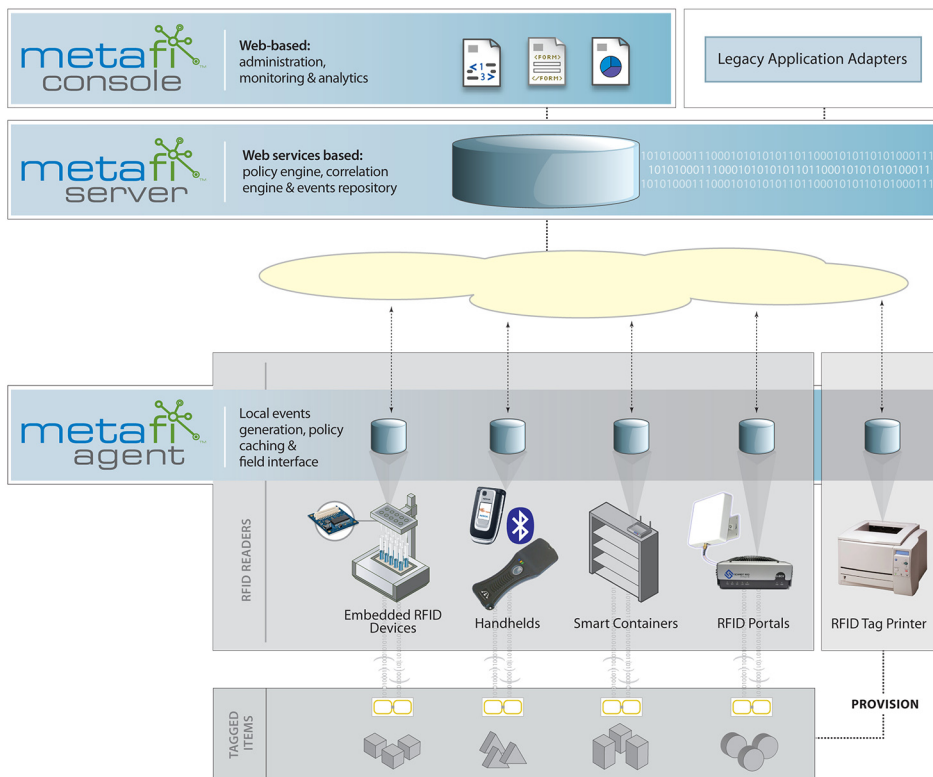

**Technical Components**

MetaFi has been designed to collect information in real-time about specific entities in off-premises locations, either remote or mobile, as well on-premises locations. As such, it is comprised of the following:

**MetaFi Console:** Web-based graphical user interface for administering, monitoring and analyzing data collected from mobile and fixed RFID readers. The Monitoring modules provide business dashboards that are user configurable allowing prioritization of the most important metrics, messages, and alerts. Summary-level as well as detailed information about inventory levels, product location, and employee activity is also provided. Intuitive filtering and search capabilities allow drill-down to specific products, locations, and employees. The tag commissioning process is managed via the Provisioning module while entities (both people and items), policies, events, and users are defined and managed in the Configuration module.

**MetaFi Server:** The engine of the MetaFi solution comprised of core web services (eg, policy service, event service, etc.), message bus, databases, and external XML-based interfaces. All of these components are consumed by the MetaFi Console as well as external 3rd-party applications such as ERP, Accounting, Inventory Management, POS, and other commercial or proprietary back-end systems.

**MetaFi Agent:** Serves as the smart edge of the solution to allow mobile or fixed readers to capture and act on inventory levels even when operating in a location lacking local network connectivity and/or when not connected to the MetaFi Server. The MetaFi Agent is essentially a lightweight version of the MetaFi Server designed to run on handhelds and readers as well as drive printers/encoders for tag provisioning.

**RFID Tag and Reader Support:** SkyeTek partners with 3rd-party manufacturers of RFID tags, fixed readers, handheld readers, and printers to meet the needs of a given MetaFi deployment. For smart-cabinets / -shelves / -containers, SkyeTek will work with customers to outfit fixtures with finished or embeddable RFID readers and antennas.

**Mobile Phone / Smartphone / Handheld Support:** The MetaFi Agent runs on devices that support Windows Mobile and Java Mobile Edition (aka J2ME).

**Get Started Now**

MetaFi's web-based delivery and subscription model means organizations can get up and running in less than 30 days. SkyeTek Professional Services group is also available to review customer needs and architect corresponding RFID solutions that tie seamlessly with existing legacy systems. Contact SkyeTek today to realize the true potential of your sales organization and field service representatives.

**Other Offerings from SkyeTek** SkyeTek provides a variety of reader technology and web services software at both 13.56 MHz (HF) and 860- 960 MHz (UHF). ReaderDNA, a comprehensive reference design, is available for component level integration of the technology including complete design files, BOM, and test fixture. SkyeOS, the embedded software intelligence of the RFID reader, is available to ReaderDNA customers. All SkyeModules are controlled via the SkyeTek Protocol, a powerful but simple communication protocol that grants the user access to all features of an RFID transponder. Further, they have been designed with flexible and modular embedded software that allows one to select only the features desired.

